

EDWARDS

Homes of El Paso, L.L.C.

Plan Victoria IV

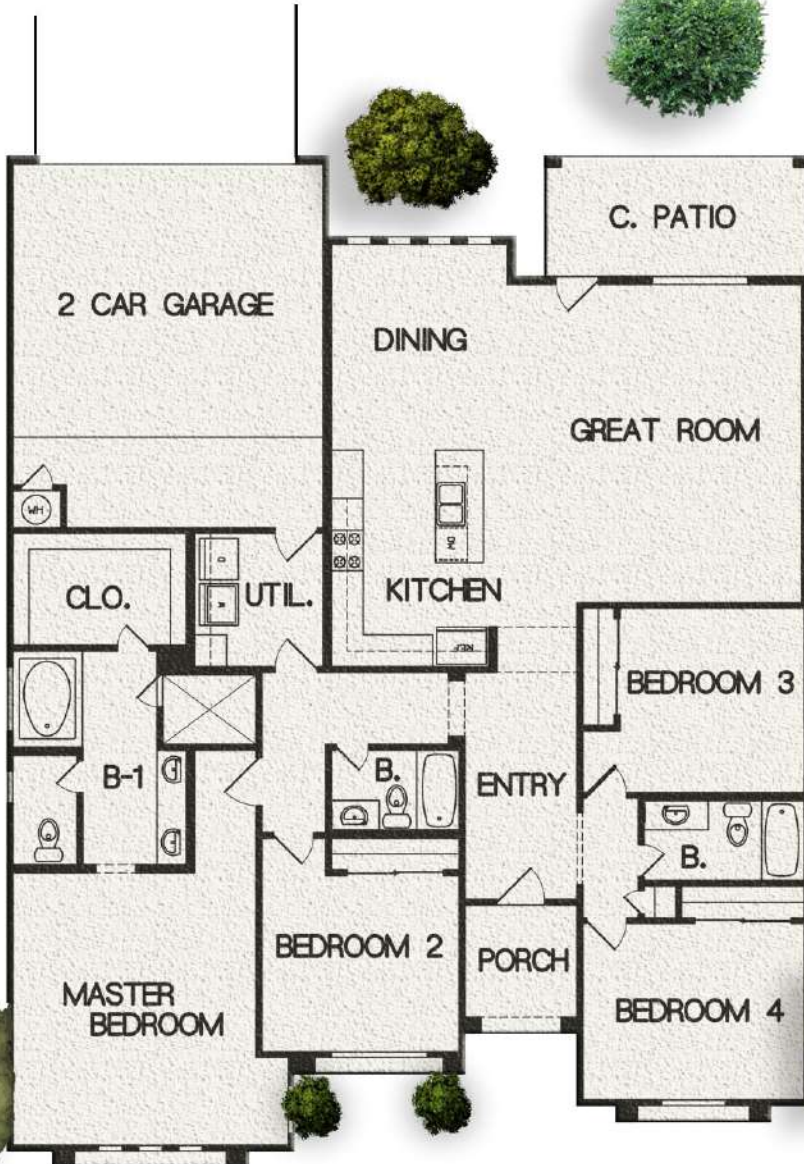

This exceptional Victoria IV floor plan is a must-see for families seeking ample living space. Boasting 2236 square feet of livable area, this home features 4 bedrooms and 3 bathrooms, along with an open walk-through kitchen featuring stainless steel appliances and granite countertops. Don't miss the opportunity to view this model home!

Price Starting at: \$263,950.00

Beds:	4
Baths:	3
Level:	1
Square Feet:	2236

Call Us!
(915) 849-8819

Floor Plan